



Carlow Advance Building Solution

IDA Business & Technology Park,
Dublin Road,
Co. Carlow

 **IDA Ireland**

Building details

- Advance Building Solution of c. 3,140 m² (c. 33,801 ft²) on a site area of c. 2.34 hectares (c. 5.78 acres)
- Technology / Manufacturing space of c. 1,679 m² (c. 18,077 ft²) with roller shutter doors to service yard.
- Clear internal eaves height of c. 7.20 m
- Ancillary space totalling c. 1,157 m² (c. 12,454 ft²) including office space over two floors (with raised access floors, suspended ceilings, lighting, air conditioning) showers, toilets and common areas.
- Surface car parking for 70 cars, 4 accessible, 2x EV charging terminals and cycle parking onsite

Sustainability

- Energy Rating (BER) Certification B1
- Designed to achieve LEED CS accreditation and nZEB compliance

Specification

GROUND FLOOR PLAN

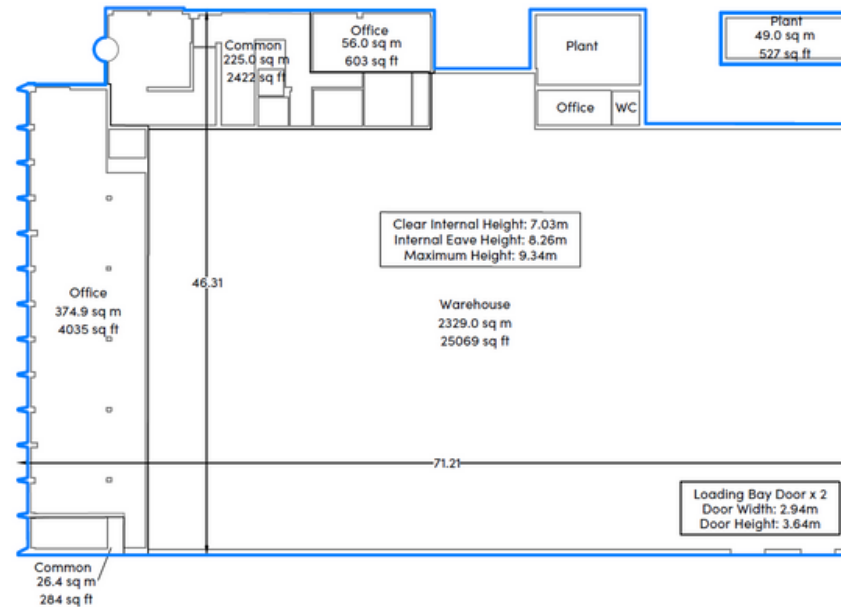

FIRST FLOOR PLAN

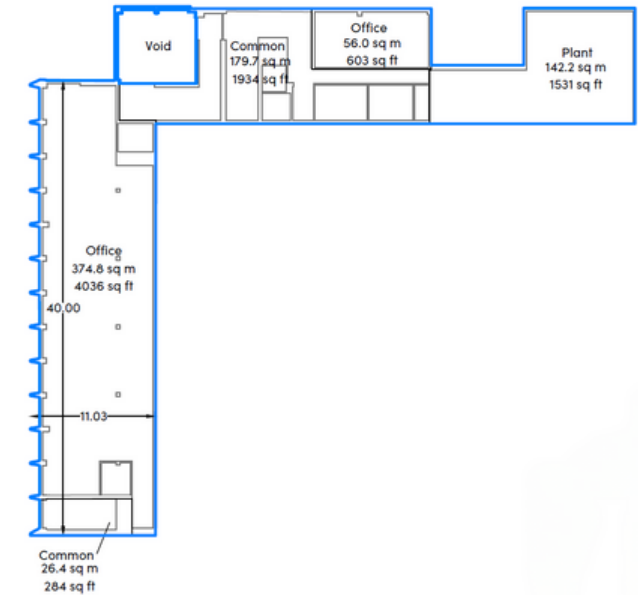

Production Space

- c. 1,679 m²
- c. 18,077 ft²

Ground Floor Office

- c. 389 m²
- c 4,187 ft²

First Floor Office

- c. 392 m²
- c.4,219 ft²

Total Floor Area

- c. 3,140 m²
- c. 33,801 ft²

Accessibility

Dublin City - 84 km drive
Waterford City - 80 km drive
Wexford Town - 76 km drive

Dublin Airport - 177 km
Shannon Airport - 155 km
Cork Airport - 127 km

Excellent rail links to Dublin's
Heuston Station

Rosslare Europort - 93 km
Port of Waterford (Belview) - 84 km
Dublin Port - 103 km

Companies in the region include
MSD, Unum, Netwatch and Alltech

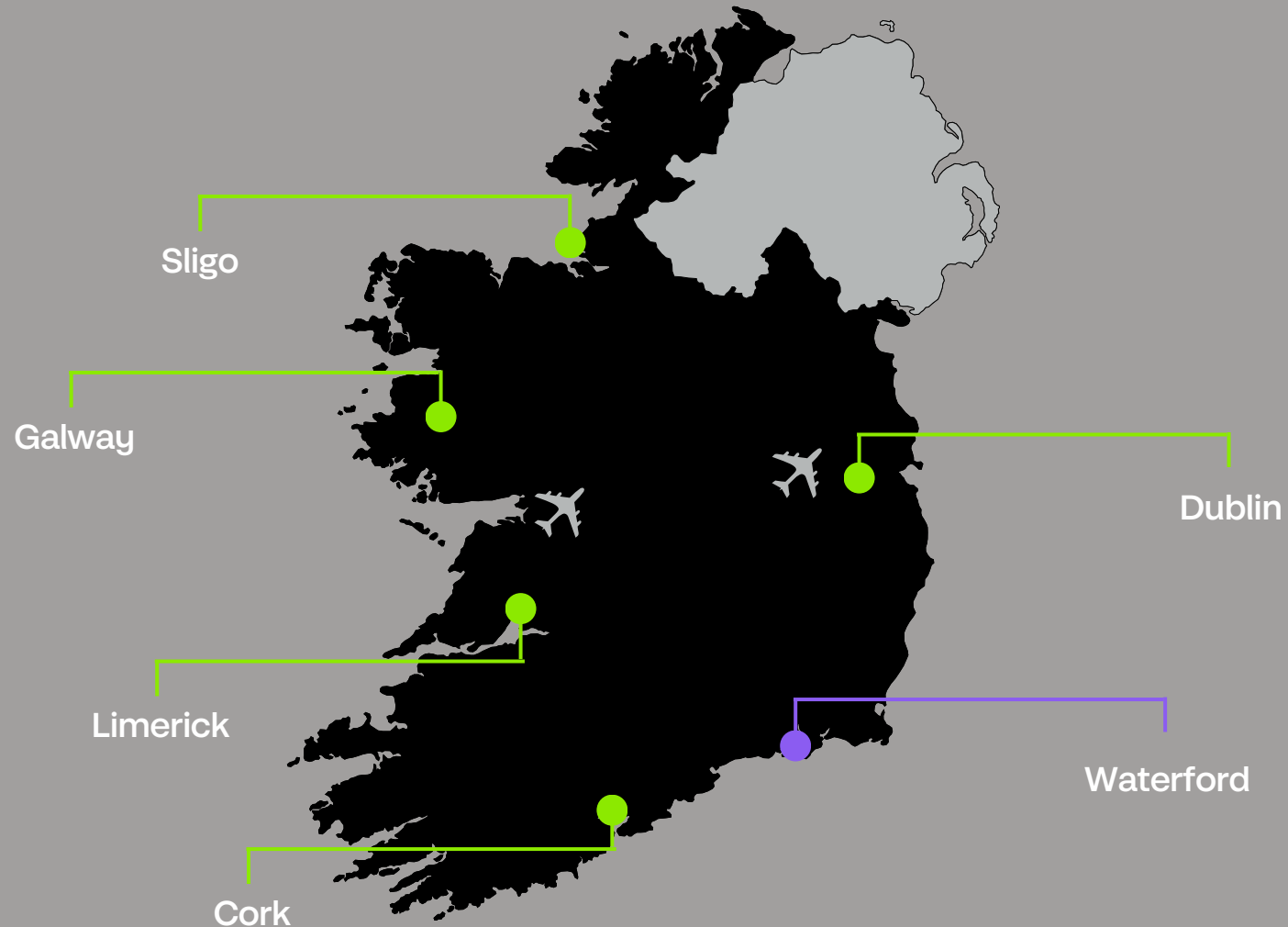



Exterior



Interior



Manufacturing area



Exterior



3D Virtual Tour



IDA Ireland

Contact our team

IDA Property Sales & Marketing, Athlone

t +353 90 6471500 | marketing.property@ida.ie | www.idaireland.com